



# "The Orca": 50ft Sportfish Yacht

Midshipman 1/C Smith, McShan, Turner

Professor Jaye Falls | Naval Architecture and Marine Engineering



## Mission

The vessel integrates modern marine methods and technologies to deliver a product that is cost-effective and family friendly, while maintaining the performance and comfort expected in the sport fishing industry. Intended for operation in coastal areas, this sport fishing vessel intends to bridge the gap between tournament-winning sport fishers, and a weekend family cruiser.



## Principal Characteristics

LOA	50	ft
Beam	18.7	ft
Displacement	28.8	LT
Max Speed	30	kts
Fn	1.6	
Fn_vol	2.8	
BHP	1800	HP
Berths	8	
State Rooms	3	

## General Arrangements

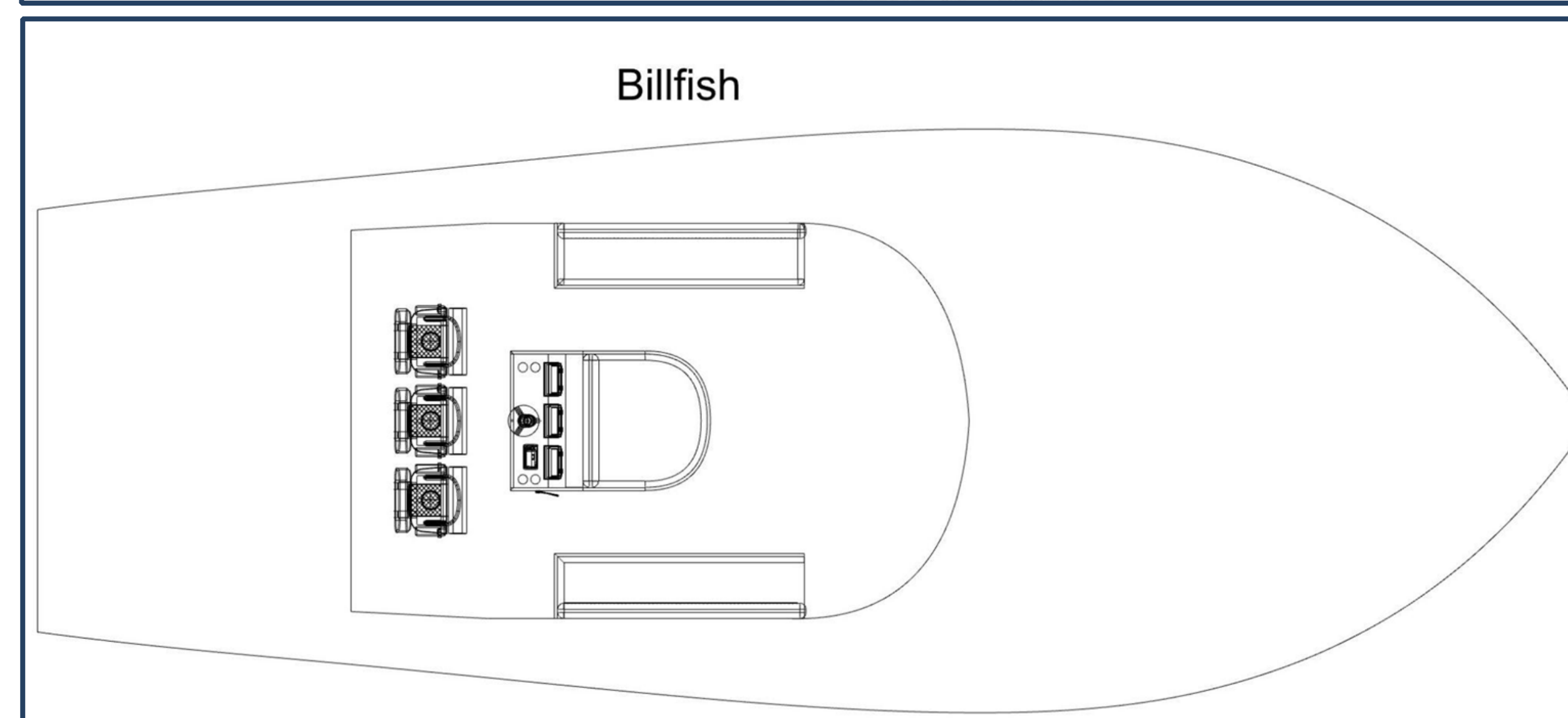
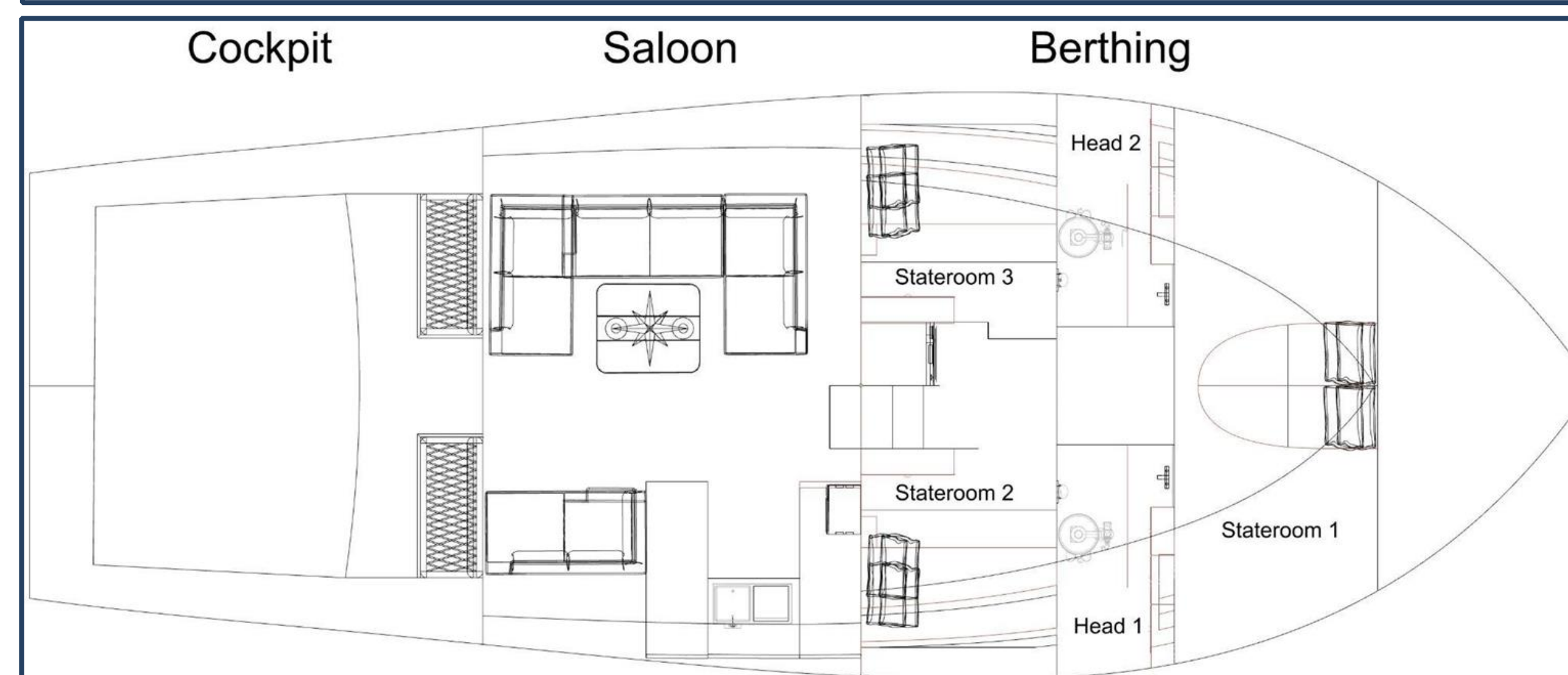
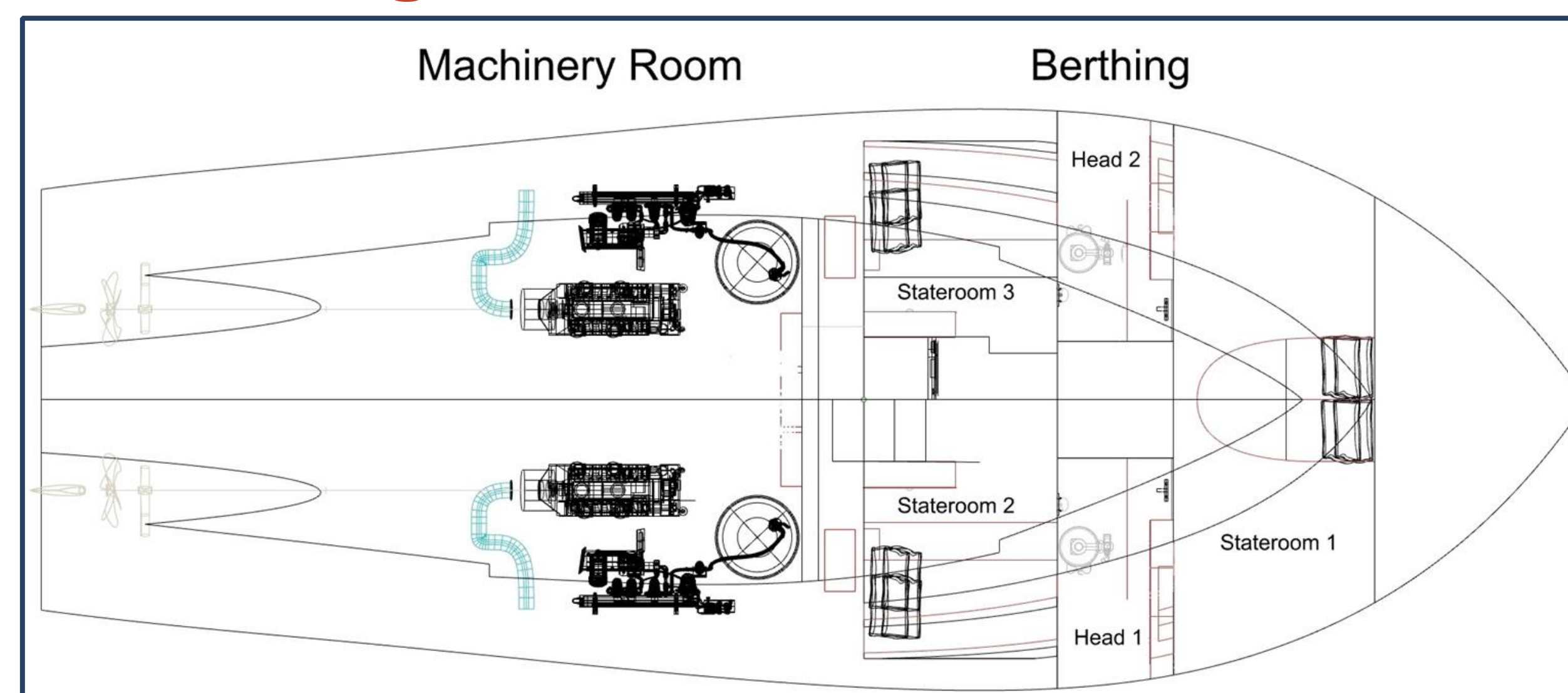

## Key Features

- 3 Staterooms
- Honeymoon suit capable
- 2 Full heads
- 3 Live wells
- 3 Garmin Fish Finders
- 6 Rod holders
- Charter capable
- Serviceable in 100+ countries
- 450NM range
- Cost: ~ \$1.87M
- MaxPass: 15

## Acknowledgements

- Professor Falls
- Professor Morabito
- The Naval Architecture Department
- Iver Franzen